

# AC Leakage Current Clamp

368 FC/369 FC

## LOG



on/off LOG



## Clear Memory



+



5 sec



# Fluke Connect® Bluetooth Connection to FC Tools

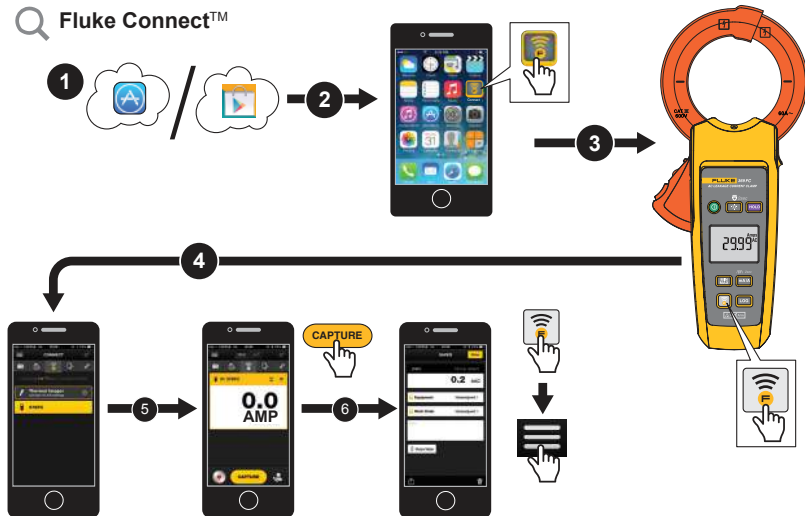

## Specifications

Radio Frequency Certification ..... FCC ID:T68-FBLE IC:6627A-FBLE

Wireless Radio Frequency Range ..... 2412 MHz to 2462 MHz

Output Power ..... <100 mW

See the 368/369 Users Manual for other specifications.

## Radio Frequency Data

Search for "Radio Frequency Data for Class A" (PN 4333628) on the Fluke website.

Go to [www.flukeconnect.com](http://www.flukeconnect.com)